

# Curtarra Custom Curtain Track Installation Instruction

## Packing List:

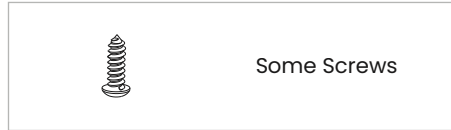
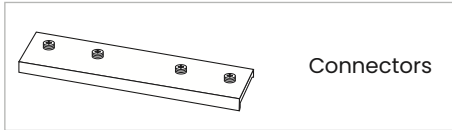
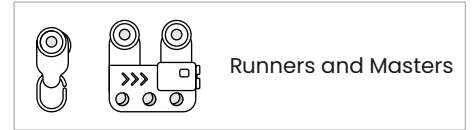
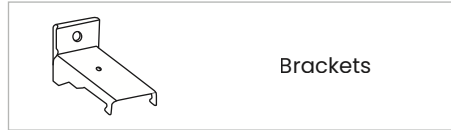
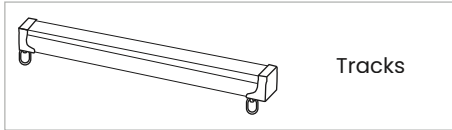

The track will come fully assembled with runners and masters. Brackets are packaged separately.

## Tools You'll Need:



Screwdriver



Level

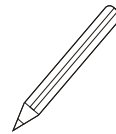

Pencil

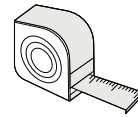

Measuring Tape

## Install Connector

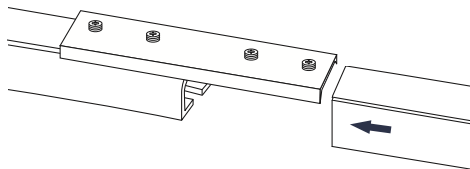

1

1. Insert the connector above the curtain track.

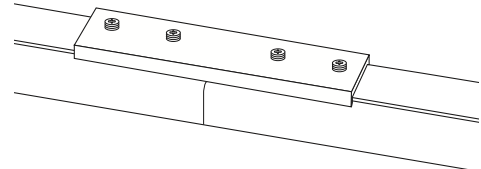

2

2. Combine the two curtain tracks to ensure there is no gap.

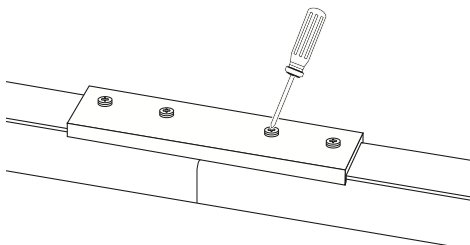

3

3. Tighten the screws with a screwdriver.

Your spliced tracks will come in sections when the track is over 70 inches. With the tracks on the floor, connect the 2 (or more) sections of the track. Once tracks are connected into one piece you can proceed to mount tracks onto brackets that are installed into the ceiling/wall. It is important to mount brackets on both sides of the splice connector for support and stability.

# Curtarra Custom Curtain Track Installation Instruction

## Wall Mounted

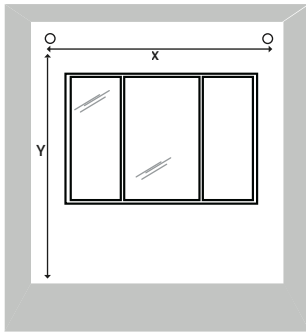

1. Use the tool to mark the brackets' position, and make them level and straight.

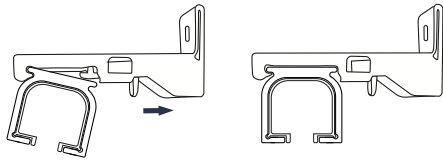

3. Attach the track to the brackets.

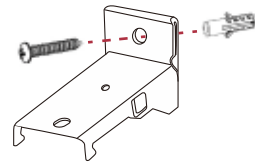

2. Install the brackets with screws.

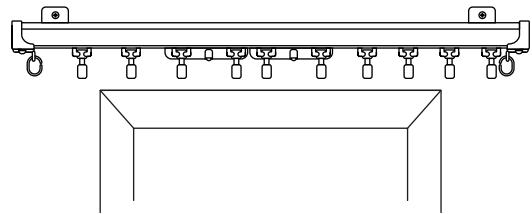

4. All done. You can attach the drapery panel to the runners.

## Ceiling Mounted

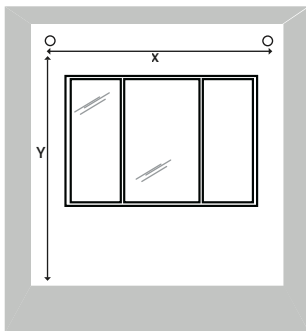

1. Use the tool to mark the brackets' position, and make them level and straight.

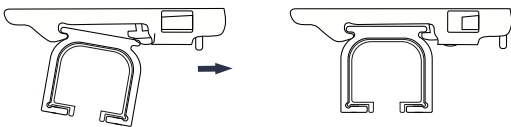

3. Attach the track to the brackets.

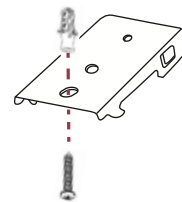

2. Install the brackets with screws.

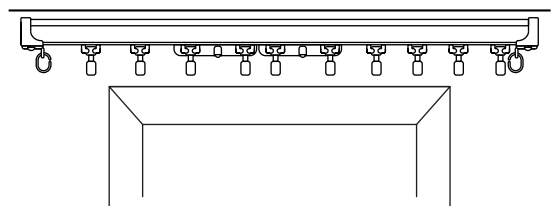

4. All done. You can attach the drapery panel to the runners.