

# Curtain Rod Installation Instruction

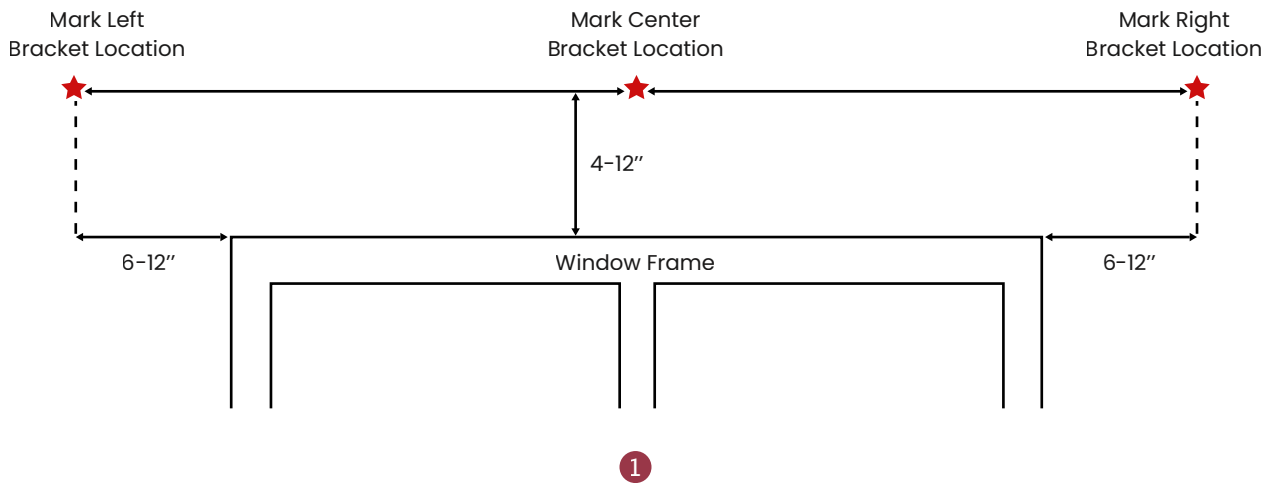

1. For a superior look, mount above and beyond the window frame to allow the molding to be visible, to make the window look larger, and to let more light in when the curtains are open. Mark the locations of the brackets.

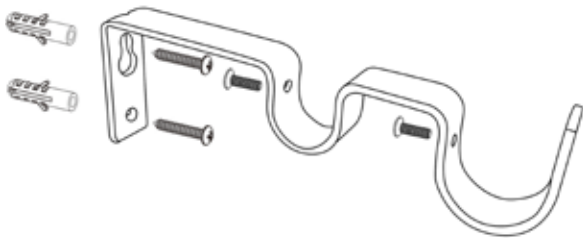

2

2. Use a stud finder to determine if there are beams at the locations you marked. Use a 3/32" straight bit for drilling pilot holes into studs. For drywall, use an 11/64" straight bit and gently tap anchors with a hammer until they are flush with the wall. Install brackets with screws. Leave the smaller screw in the bracket loop loose.

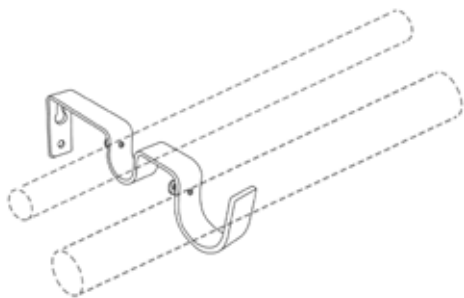

4

4. Place the rod on the bracket. You can place your curtains or rings on the rod before doing so.

## 2-Piece Telescoping Rod

For Rod Sizes: 72-144" Ø 0.63-0.75"

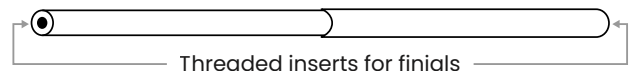

## 3-Piece Telescoping Rod

For Rod Sizes: 72-144" Ø 0.98-1.1"

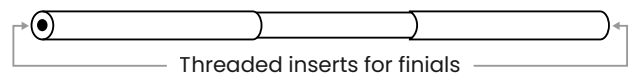

3

3. Depending on the size of the rod purchased, locate and set up the telescoping rod as depicted above. Note that for models that are 72-144", if a target width of less than 100" is required, only two rod pieces will be utilized. One of the larger diameter rods should be set aside.

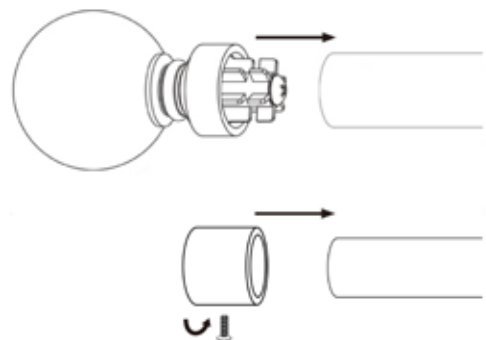

5

5. Push the finials into both ends of the rod. Tighten the small screw for the smaller rod.

# Curtain Rod Installation Instruction

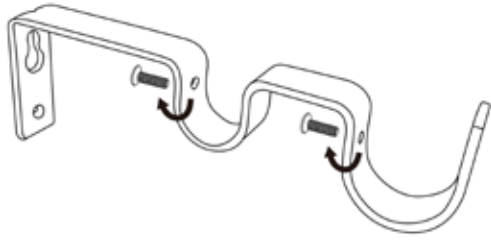

6

6. Tighten the small screw in the bracket loop to prevent the rod from sliding.

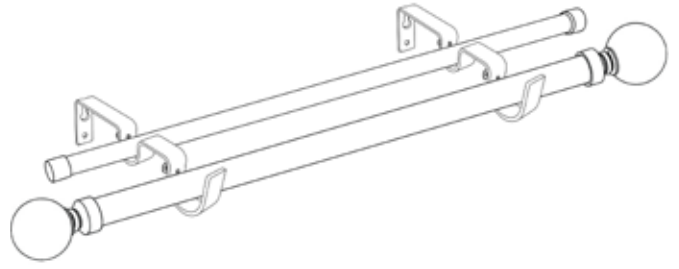

7

7. All done. You can attach the drapery panel to the rod.